

**L5-C Plus
with manual yoke (MAN)**

L1.0048800 & L1.0048801

This Technical Drawing is published by Arnold & Richter Cine Technik, 2nd April 2024 © ARRI/2024.
Technical data and offerings are subject to change without notice. All rights reserved. Without any warranty. Not binding 04/2024.

ARRI, the ARRI logo, ARRIMAX, ARRISUN, EB, **UOS**, L-Series, MAX Technology, M-Series, Orbiter, POCKETPAR, Quick Lighting Mount, QLM, True Blue, SkyPanel, SKYPANEL, Stellar, and T12 as well as the blue/silver color combination are registered trademarks of Arnold & Richter Cine Technik GmbH & Co. Betriebs KG.

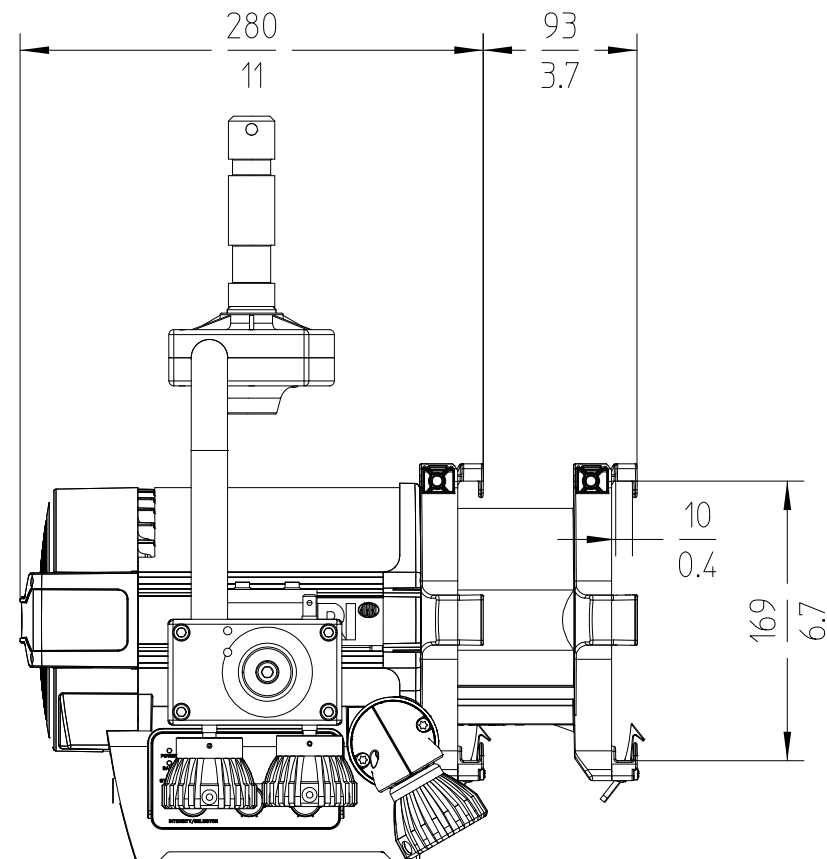
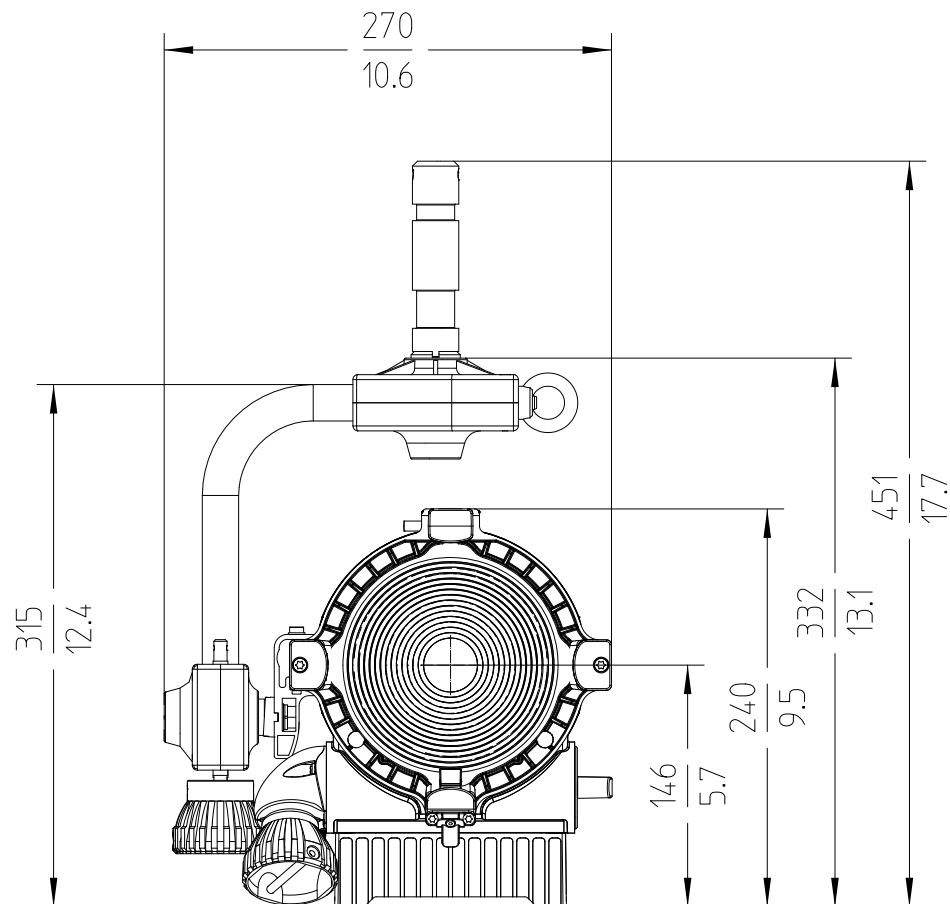

L5-C Plus
with pole operated yoke (P.O.)

L1.0048802 & L1.0048803