

Matte Box 29, MB-29 (4" x 5.65")*

* discontinued items
only as long as stock is available



CONFIGURATION OVERVIEW – 8.9.0 / 2013.05

© 2010 Arnold & Richter Cine Technik GmbH & Co. Betriebs KG. All rights reserved. This material is provided "as is" for information purposes only without any warranty. ARRI assumes no responsibility with regard to the performance or use of the products or typographical errors or inaccuracies of given information. Product specifications are subject to change without notice. For a full listing of all available components consult the price list.

Set Configurations



Set K0.60113.0
includes:
Base Module (K2.66035.0),
Filter Stage, rear only rotatable (K2.66017.0),
Swing away module (K2.66015.0),
Lightweight support (K2.65025.0),
4"x5.65" Horizontal Tray (K2.66133.0),
4"x5.65" rear Stage Tray (K4.47493.0),



Set K0.60114.0
includes:
Base Module (K2.66035.0),
Filter Stage, both rotatable (K2.66018.0),
Swing away module (K2.66015.0),
Lightweight support (K2.65025.0),
Combo 4"x5.65" Horizontal/Vertical and 5"x5" (K2.66037.0),

Filter frames

For Filter Stage
K2.66017.0



4" x 5,65" Filter frame, horizontal
K2.66133.0

4" x 5,65 Filter frame, rearstage
K4.47493.0

4" x 4" Filter frame
K2.47104.0

4" x 4" Filter frame, rearstage
K2.47105.0

For Filter Stage
K2.66018.0
K2.66118.0
K2.66119.0



4" x 5,65" / 5" x 5" Filter frame,
K2.66037.0

4" x 5,65" / 4" x 4" Filter frame,
K2.65230.0

5,65" x 5,65" Filter frame,
K2.66036.0

Accessories



Hard Matte Sets 16:9
K2.66107.0

Hard Matte Sets 35
K2.66108.0



Case for MB-18 / 20 / 29
K2.49050.0
with variable dividers

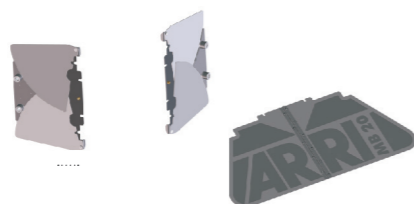

Top flag, K2.47740.0
Bottom flag, K2.47740.0
Side flag (pair), K0.60029.0

Basic Modules & Accessories

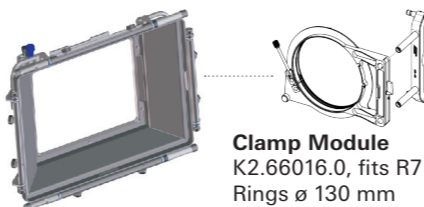

**MB-29
Basic Module
with Sunshade**
K2.66035.0

Clamp Module
K2.66016.0, fits R7
Rings ø 130 mm
see Config 8.0.0

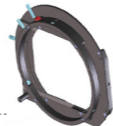

**Filter Stage
for 2 Filter frames,
rear only rotatable
(as MB-19)**
K2.66017.0



**Filter Stage
for 2 Filter frames,
both rotatable**
K2.66018.0



**Filter Stage
for 3 Filter frames,**
K2.66118.0



**Filter Stage
for 4 Filter frames,**
K2.66119.0



**Swing away
module MB- 29**
K2.66015.0



**Adapter for
lightweight support**
K2.65025.0
(requires swingaway
module)

**Adapter for
19 mm Rods**
K2.66039.0
**Adapter for
15 mm Rods**
K2.66040.0

R2 Rings 143 mm

fits in filter stages with ø 143 mm

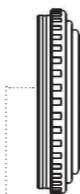

138 mm filter ring
K2.47222.0* (ø 100 mm)

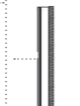

Adapter ring 143-128
with screws - allows to use
of R3 rings, K2.66086.0

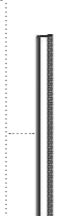

**Large Diameter Wide-Angle
Light Trap Rings** (not for clamp on ring)
reducing diameter from 143 mm to listed
diameter
K2.66268.0 (ø 136 mm)
K2.65245.0 (ø 134 mm)
K2.65073.0 (ø 132 mm)
K2.65072.0 (ø 130 mm)
K2.65090.0 (ø 128 mm)*
*for Fujinon 3 x 5 HAe Super Zoom)
K2.65071.0 (ø 128 mm)*
*not for Fujinon 3 x 5 HAe Super Zoom)
K2.65123.0 (ø 121 mm)
K2.65070.0 (ø 120 mm)
K2.65069.0 (ø 117 mm)
K2.65250.0 (Panasonic 3DA1)



Adapter Ring
Screws into R1 or R2 138mm round filter
and reduces to 114 mm (4½")
K2.49099.0

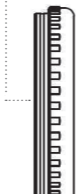

138 mm filter ring
K2.52204.0 (ø 114 mm)

138 mm filter ring
K2.47190.0 (ø 114 mm)
(wide angel; internal focus
lenses only)

R3 Rings 128 mm

fits in filter stages with ø 128 mm

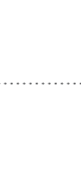

4½" (114 mm) filter ring
K2.52205.0 (ø 114 mm)
K2.49102.0 (ø 95 mm)
K2.49109.0 (ø 87 mm)

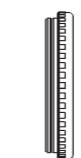

4½" (114 mm) filter ring
for tight installation situations
K2.66067.0 (ø 114 mm)

R5 Screw-In Rings 100 mm

Reduction rings (R5 | 100 mm)

K2.47224.0 (ø 95 mm)
K2.65029.0 (ø 95 mm WA)
(WA =wide angle)
K2.65054.0 (ø 92 mm)
K2.65040.0 (ø 90 mm)
K2.47225.0 (ø 87 mm)
K2.65039.0 (ø 86 mm)
K2.65147.0 (ø 85 mm WA)
K2.65038.0 (ø 85 mm)
K2.65043.0 (ø 80 mm)

R6 Screw-In Rings 87 mm

Reduction ring (R6 | 87 mm)
K2.47226.0 (ø 80 mm)

R4 Screw-In Rings 114 mm

Reduction rings (R4 | 114 mm)

K2.65045.0 (ø 110 mm)
K2.65096.0 (ø 105 mm)
K2.52195.0 (ø 104 mm)
K2.66066.0 (ø 103 mm)
K2.65046.0 (ø 100 mm)
K2.65044.0 (ø 98 mm)
K2.65055.0 (ø 96 mm)
K2.65271.0 (ø 95 mm)
K2.65273.0 (ø 95 mm WA)
K2.65156.0 (ø 94 mm)
K2.65201.0 (ø 93 mm)
K2.65163.0 (ø 91 mm)
K2.65164.0 (ø 89 mm)
K2.65272.0 (ø 87 mm)
K2.65166.0 (ø 85 mm)
K2.65232.0 (ø 82 mm)
K2.65229.0 (ø 81 mm)
K2.65165.0 (ø 80 mm)

**CAUTION: RINGS CAN VIGNETTE.
PLEASE CONTACT ARRI.**

ø = diameter of connection
ring to lens

* discontinued items, only as long
as stock is available