

COPYRIGHT:

DEUTSCH

DIESE DRUCKSCHRIFT UND ALLE IHRE BESTANDTEILE IST URHEBERRECHTLICH GESCHÜTZT.

ABBILDUNGEN, GRAFISCHE DARSTELLUNGEN, TEXTE ODER DIE DRUCKSCHRIFT INSGESAMT ODER IN TEILEN DÜRFEN NICHT OHNE VORHERIGE SCHRIFTLICHE GENEHMIGUNG NACHGEDRUCKT ODER SONST REPRODUZIERT WERDEN (Z. B. AUF CD-ROM ODER IM INTERNET).

WENN SIE DIESE PDF-DATEI FÜR IHREN PERSÖNLICHEN GEBRAUCH VON UNSERER INTERNET-SEITE KOPIERT HABEN, MÖCHTEN WIR DARAUF HINWEISEN, DASS ALLE DORT ZUR VERFÜGUNG GESTELLTEN DATEIEN OHNE JEDEN WEITERN HINWEIS AUF DEN NEUESTEN TECHNISCHEN STAND GEBRACHT WERDEN. DIE ÄNDERUNG VON TECHNISCHEN DATEN UND LIEFERUMFANG IST DAHER VORBEHALTEN.

COPYRIGHT:

ENGLISH

ALL ARTWORK, PICTURES AND TEXTS ARE COVERED BY OUR COPY-RIGHT.

THEY MUST NOT BE COPIED FOR REPRODUCTION (E.G. ON CD-ROM DISKS OR INTERNET-SITES) OR USED IN THEIR ENTIRE FORM OR IN EXCERPTS WITHOUT OUR PREVIOUS WRITTEN AGREEMENT.

IF YOU ARE DOWNLOADING PDF-FILES FROM OUR INTERNET HOME-PAGE FOR YOUR PERSONAL USE, MAKE SURE TO CHECK FOR UPDATED VERSIONS.

WE CANNOT TAKE ANY LIABILITY WHATSOEVER FOR DOWNLOADED FILES, AS TECHNICAL DATA ARE SUBJECT TO CHANGE WITHOUT NOTICE.

ARRI



MB-18



4"x5,65"
Production Matte Box MB-18

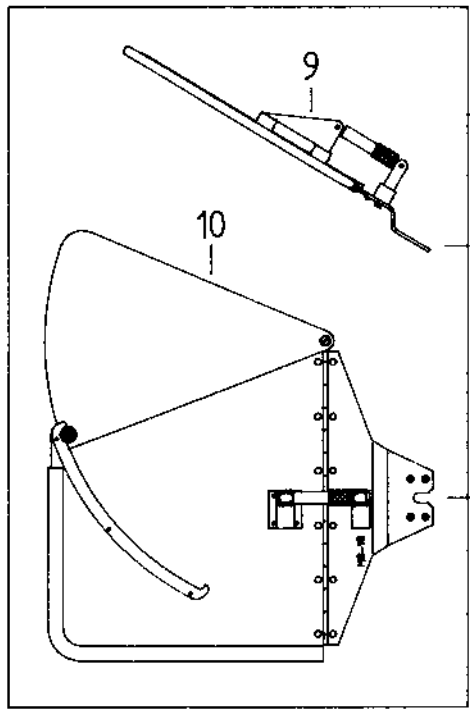

8

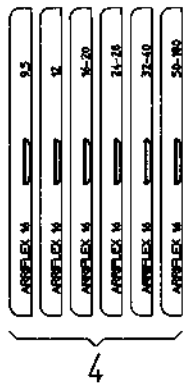

4

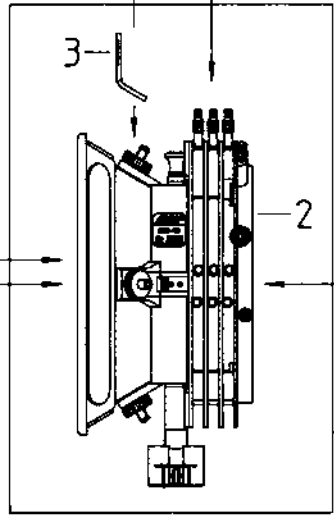

2

1

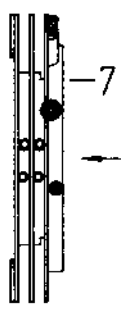

7

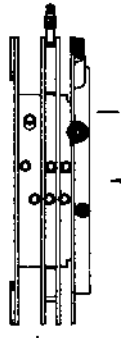

6

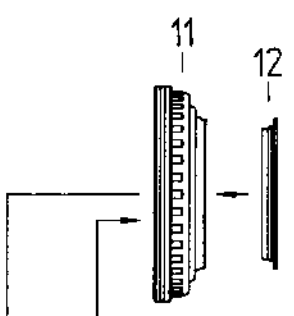

11

12

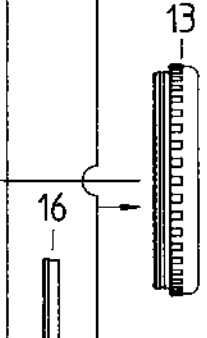

13

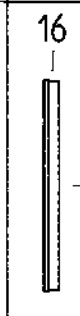

16

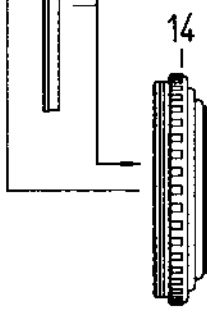

14

15

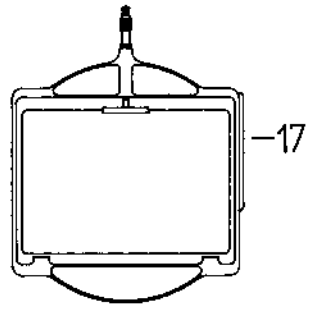

17

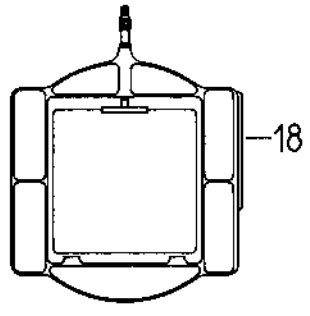

18

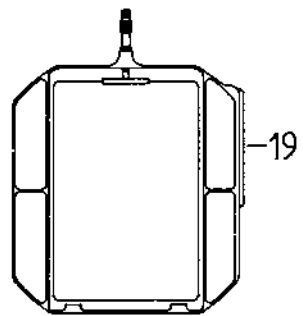

19

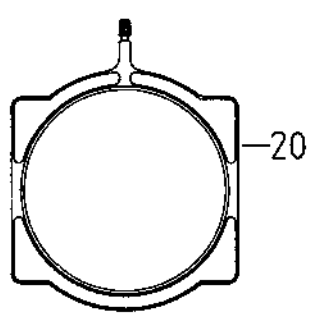

20

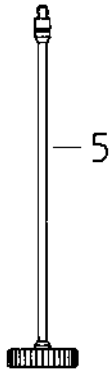

5

The 4"x5,65" Production Matte Box MB-18 System

Item	Ident.No.	Description
1	K2.47178.0	4"x5.65" Production matte box MB-18 (for support rods 19 mm dia.) with 3 x filter stage and french flag holder
	K2.47178.A	4"x5.65" Productions matte box MB-18 (for support rods 15 mm dia.) with 3 x filter stage and french flag holder
2	K4.47351.0	3 x filter stage for three 4"x5.65" push-through filters, individually rotatable (incl. in item 1)
3	K5.47876.0	French flag holder (incl. in item 1)
4	K2.47181.0	Set of masks for 35 mm 18-180 mm lenses
	K2.47182.0	Set of masks for 16 mm 9.5-180 mm lenses
5	K2.34890.0	Flexible drive shaft for graduated filters
6	K2.47179.0	4 x filter stage for four 4"x5.65" push-through filters (two rotatable in pairs, two individually)
7	K2.47180.0	2 x filter stage for two 4"x5.65" push-through filters (individually rotatable)
8	K0.59990.0	Light trap set (top/bottom K2.47183.0, lateral K2.47184.0/pair)
9	K2.47183.0	Light trap top/bottom (incl. in item 8)
10	K2.47184.0	Light trap lateral/pair (incl. in item 8)
11	K2.47223.0	138 mm filter ring with retaining ring 87 mm dia. for Zeiss Vario-Sonnar T2/10-100 II and T2.2/11-110
12	K2.47226.0	Insert ring 80 mm dia. for prime lenses and Zeiss Vario-Sonnar T2/10-100 (item 11 necessary)
13	K2.47190.0	138 mm filter ring with retaining ring 114 mm for Zeiss Distagon 1.8/14 and Angenieux 10-120/11.5-138
14	K2.47222.0	138 mm filter ring with retaining ring 100 mm dia.
15	K2.47224.0	Insert ring 95 mm dia. for Canon 7-56 and 8-64 and 11.5-138 (item 14 necessary)
	K2.47225.0	Insert ring 87 mm dia. for Zeiss Vario-Sonnar T2/10-100 II and T2.2/11-110 and Century T1.9/6 (item 14 necessary)
16	K2.49099.0	Adapter for 4 1/2" round filter (for items 11, 13 and 14)
17	K2.49083.0	4"x5.65" filter frame, horizontal
	K2.49096.0	4"x5.65" filter frame, horizontal, toothed
18	K2.47185.0	4"x4" filter frame
	K2.47186.0	4"x4" filter frame, toothed
19	K2.49027.0	4"x6" filter frame, toothed
20	K2.49023.0	Filter frame for 138 mm round filters
	K4.47359.0	4"x5.65" filter frame (spare)
	K4.47361.0	4"x5.65" filter frame, toothed (spare)
	K2.49050.0	Case for production matte box and accessories (variable dividers)

4" x 5.65" Production Matte Box MB-18

The MB-18 production matte box comes standard with a 3x filter stage for three push-through-filters (individually rotatable). One of the filter frames is toothed for operation by turning knob or flexible shaft. At the rear of the filter stage there is a receptacle for 138 mm filter rings. The 3x filter stage can be interchanged against other filter stages. For easy lens changing the matte box swings open 90°. A French Flag holder is included with the matte box.

Technical data:

Minimal focal length 35 mm lenses (Super 35)	14 mm
Minimal focal length 16 mm lenses (Super 16)	7 mm
Max. numbers of filters (with 4x filter stage)	four 4" x 5,65" filters and one 138 mm round filter
Dimensions	300 x 250 x 115 mm (11.8 x 9.8 x 4.5 in)
Weight	approx. 1450 g (3 lbs.)



ARNOLD & RICHTER CINE TECHNIK

TÜRKENSTR. 89 • D-80799 MÜNCHEN • TEL. (089) 3809-0
FAX (089) 3809-1244 • <http://www.arri.com>